

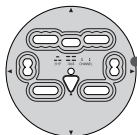

# BINDING FLOWCABULARY

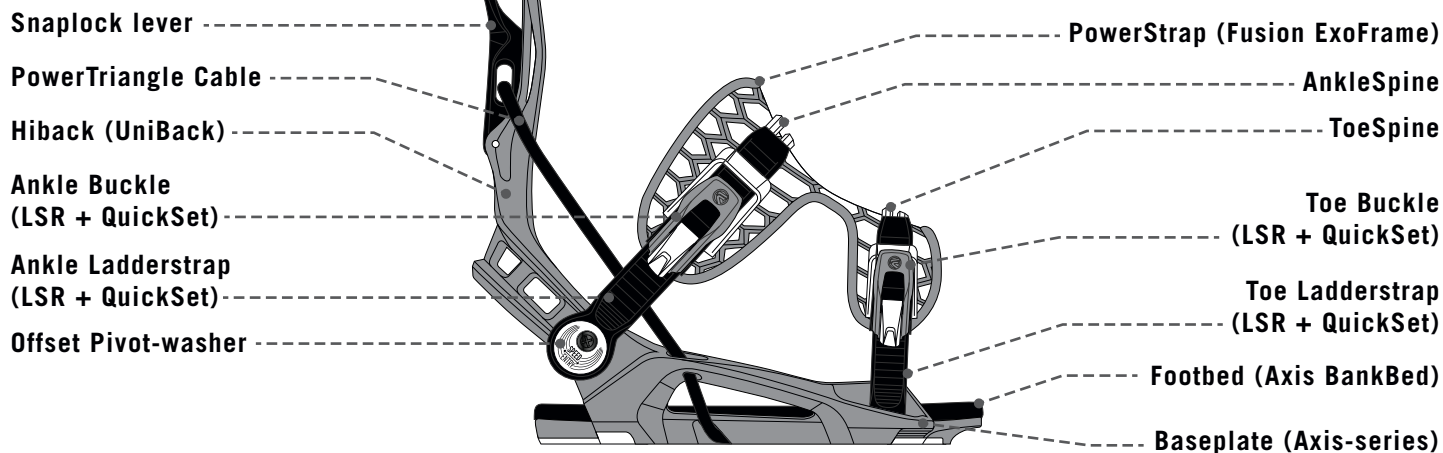

Mounting disk  
(Fuse Multi-disk: 4x4, 4x2, 3HP, Channel)

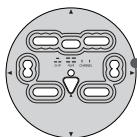
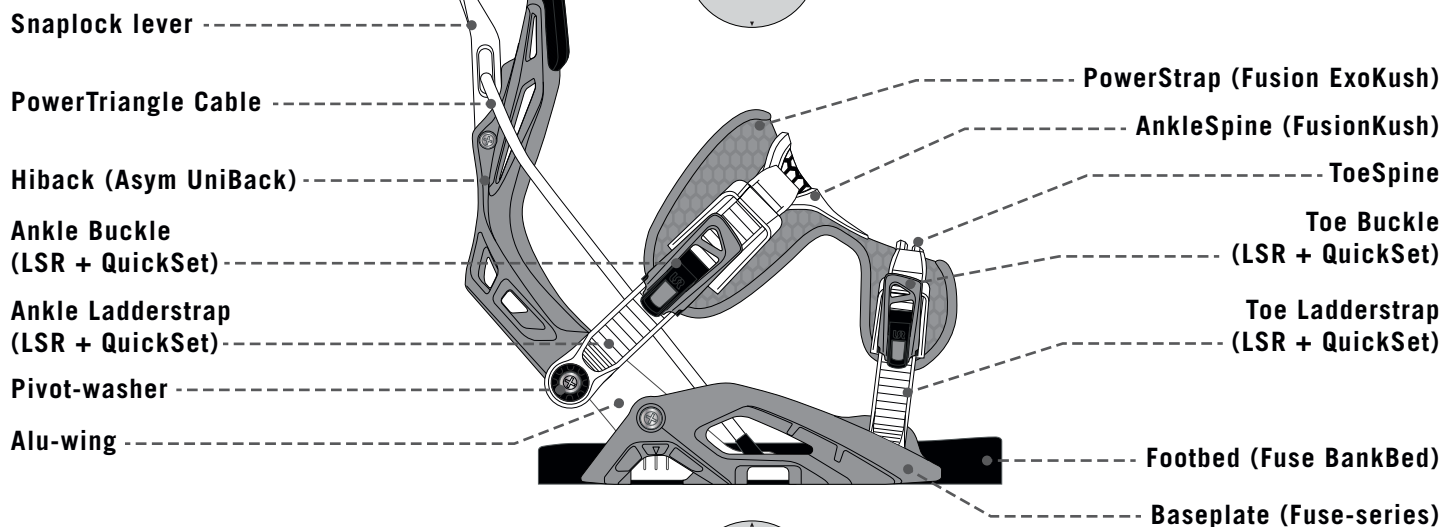

Mounting disk  
(Fuse Multi-disk: 4x4, 4x2, 3HP, Channel)

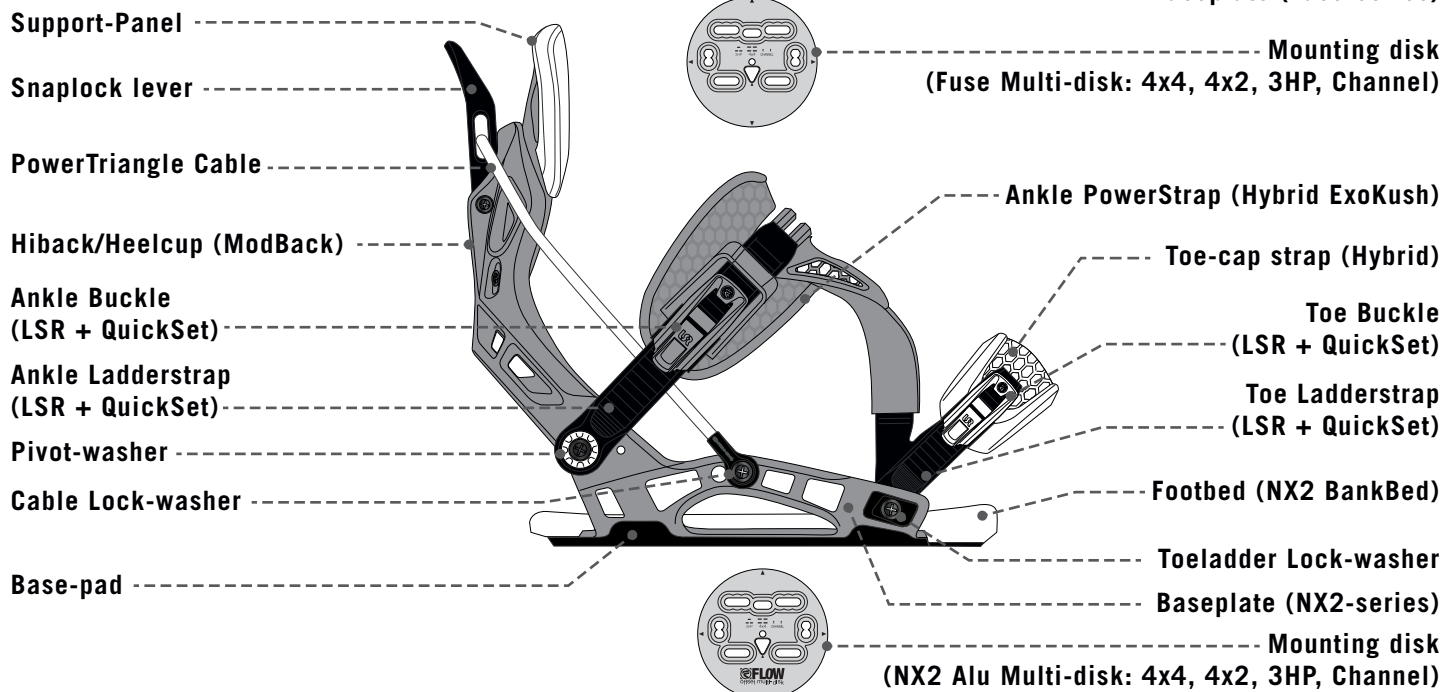



# BUCKLE REPLACEMENT

If buckle is attached by screw, please use Philips #2 Screwdriver to replace.

If buckle is attached by rivet, please follow instructions below:

Drill rivet from underside, use 1/4" drill-bit (for steel).

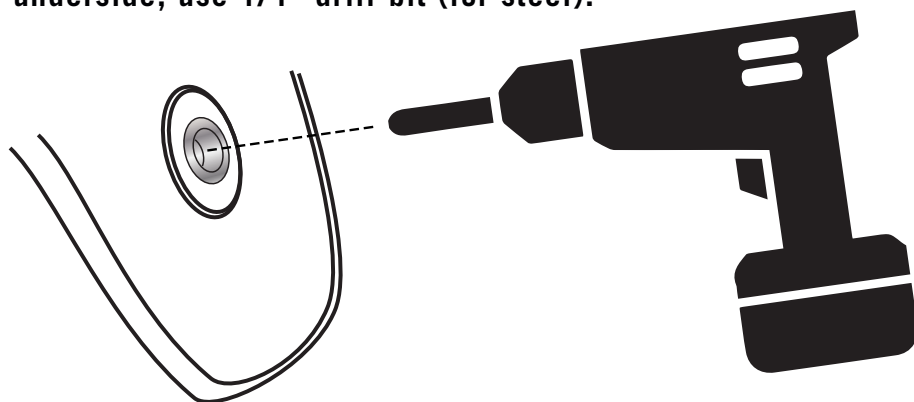

Remove old rivet and washer, and place 'spike T-nut' into hole on underside of strap.

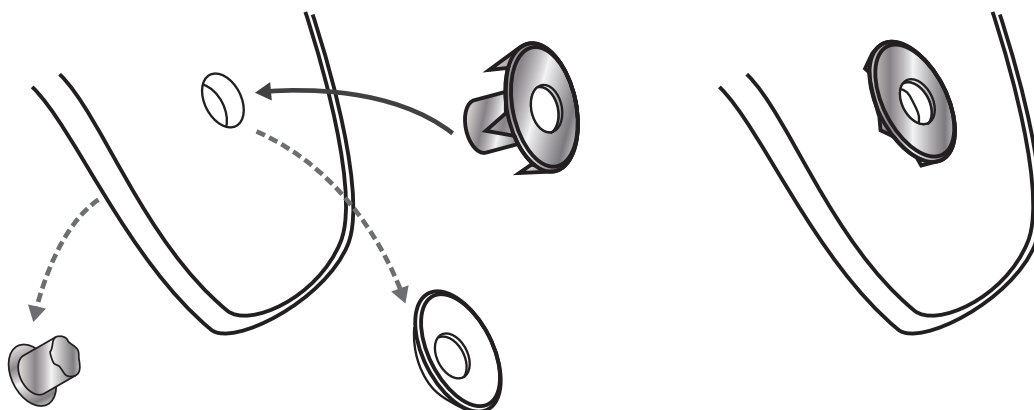

On topside, attach buckle with supplied screw into spiked T-nut, using Philips #2 screwdriver.

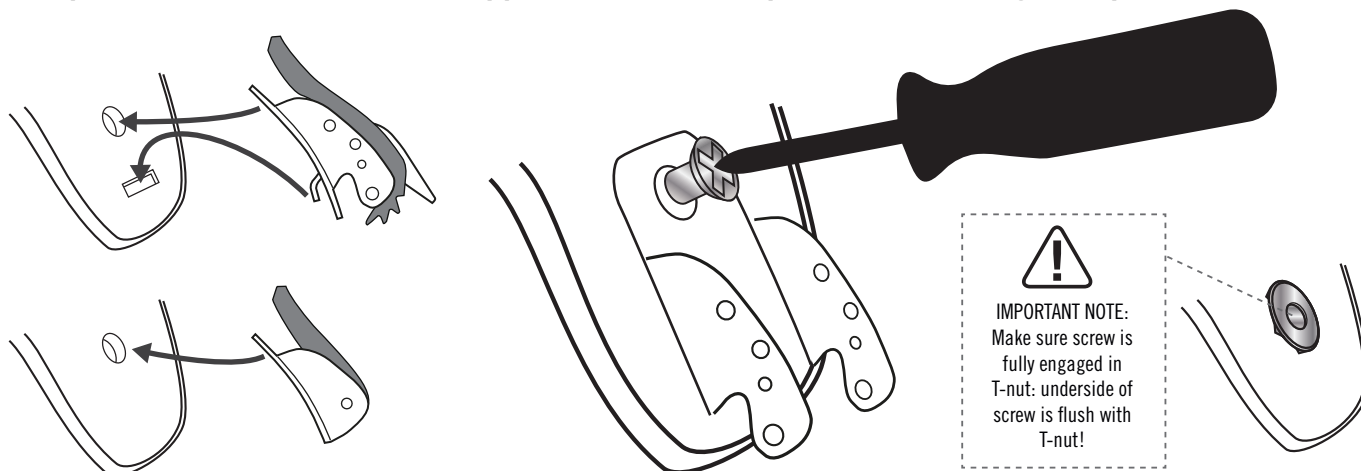

**IMPORTANT NOTE:**  
Make sure screw is  
fully engaged in  
T-nut: underside of  
screw is flush with  
T-nut!

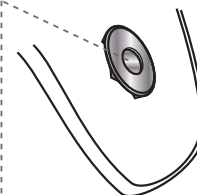

**IMPORTANT NOTE:** Be sure that all parts are assembled correctly and secure, failure to do so may cause serious injuries. Flow recommends that any and all service and repairs to your bindings be done by a trained, professional mechanic. For our full liability policy, how-to tricks and tips and more, please visit [WWW.FLOW-SNOWBOARDING.COM](http://WWW.FLOW-SNOWBOARDING.COM)



## Flite, Micron, H and AXIS-series UniBack

Remove hiback bolts and nuts on both sides with Philips #3 screwdriver.

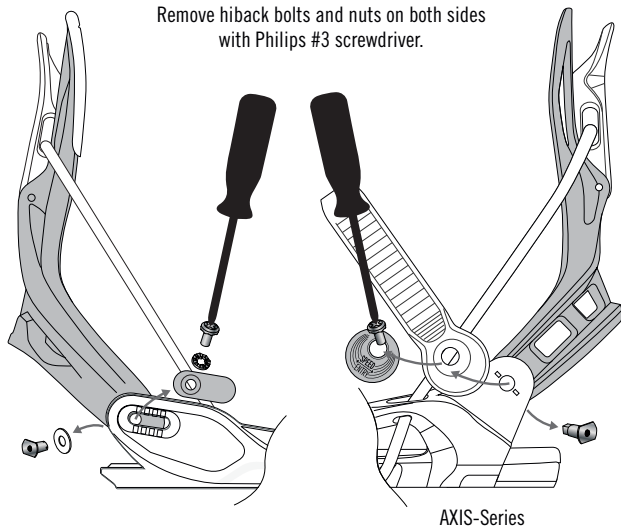

AXIS-Series

Undo U-shaped cable-termination on bottom of baseplate to disassemble and re-assemble cable through the snaplock. Place U-shaped cable termination back into the original position.

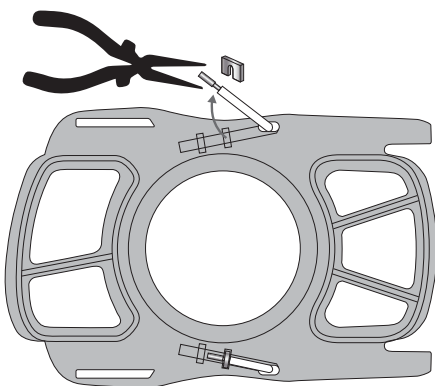

Re-assemble the hiback, and tighten the hiback bolts and nuts on both sides with Philips #3 screwdriver.

If you have not done so already, do not forget to re-assemble the cable-termination on the bottom of the baseplate, into the original position.

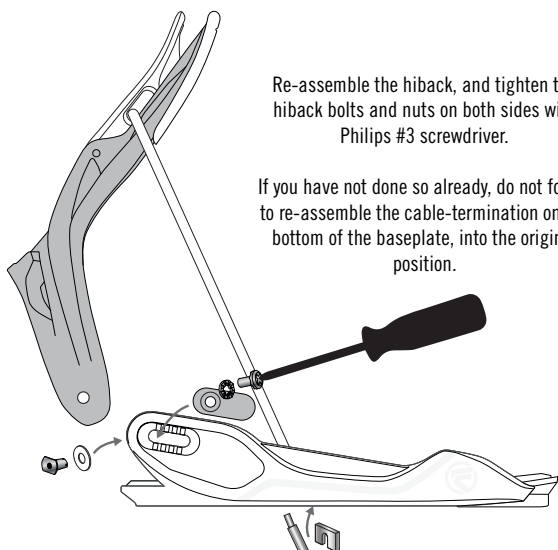

## Fuse and NX2-series Asym Uniback + ModBack

Remove ladder-strap bolts and T-nuts on both sides with Philips #3 screwdriver.

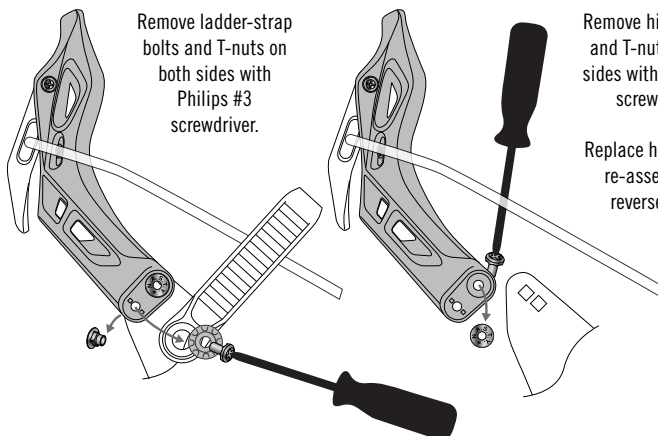

Remove hiback bolts and T-nuts on both sides with Philips #3 screwdriver.

Replace hiback, and re-assemble in reverse order.

## Fuse-GT and NX2-GT series Aluminum ModBack

Remove ladder-strap bolts and T-nuts on both sides with Philips #3 screwdriver.

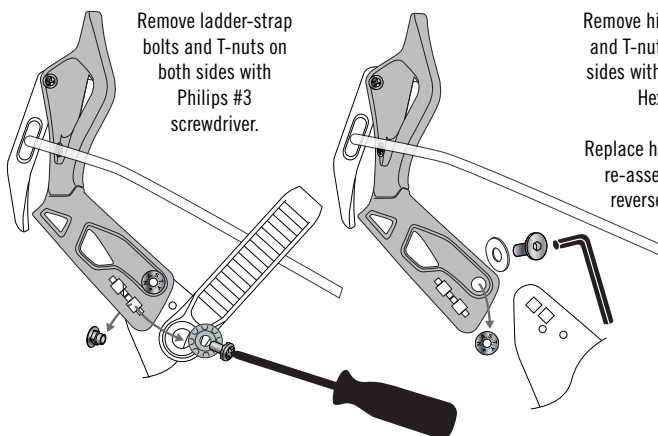

Remove hiback bolts and T-nuts on both sides with Allen-key Hex#4

Replace hiback, and re-assemble in reverse order.

## Undo the cable-termination from baseplate to disassemble and re-assemble cable through the snaplock.

On NX2-Series: Loosen Cable-termination bolt with Philips #3 screwdriver. Reassemble back in same position, make sure bolt is securely tightened.

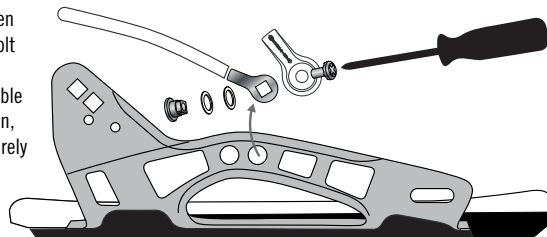

On FUSE-Series: Undo side-wing bolt with Philips #3 screwdriver. Tilt side-wing to undo cable-termination pin. Reassemble back in same position and make sure bolt is securely tightened.

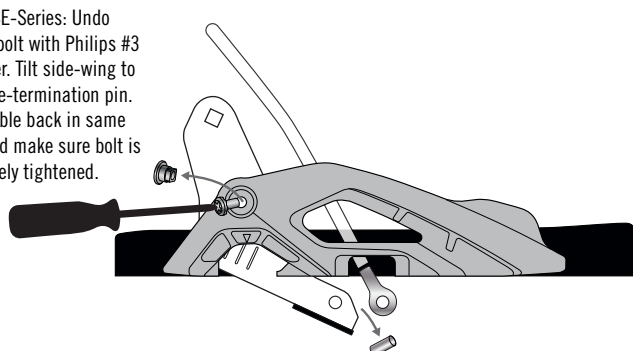

**IMPORTANT NOTE:** Be sure that all parts are assembled correctly and secure, failure to do so may cause serious injuries. Flow recommends that any and all service and repairs to your bindings be done by a trained, professional mechanic. For our full liability policy, how-to tricks and tips and more, please visit [WWW.FLOW-SNOWBOARDING.COM](http://WWW.FLOW-SNOWBOARDING.COM)



## Flite, Micron, H and AXIS-series

Remove old Pin and O-clips:  
use new Pin (or small  
screwdriver or nail/pin) to  
push out old Pin and take  
out the O-clips.



**IMPORTANT NOTE:**  
Hammer Pin  
in direction of O-clip  
teeth!

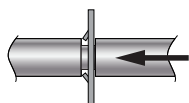

Discard old Pin and  
O-clips.

Insert new O-clips with  
teeth in same direction  
as new Pin is pushed in.

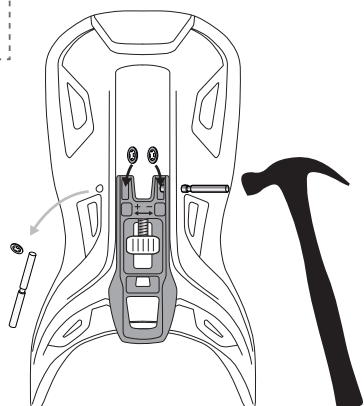
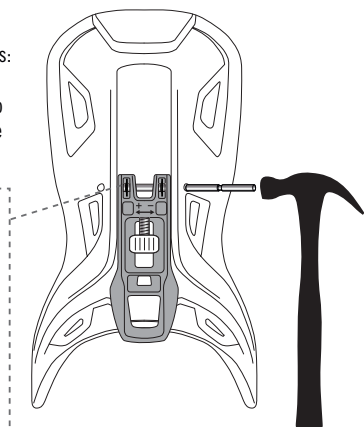

Push new O-clips in fully.  
Check secure locking of  
Pin and O-clips, and  
proper function of  
Snaplock Lever.



**IMPORTANT NOTE:**  
Make sure O-clips  
fully engage the  
grooves in the Pin!

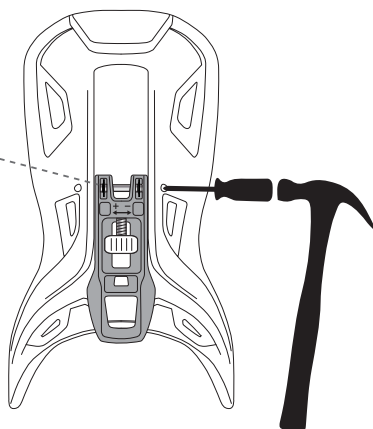
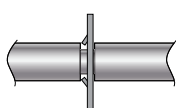

Undo U-shaped  
cable-termination on  
bottom of baseplate to  
disassemble and  
re-assemble cable  
through the snaplock.  
Place U-shaped cable  
termination back into the  
original position.

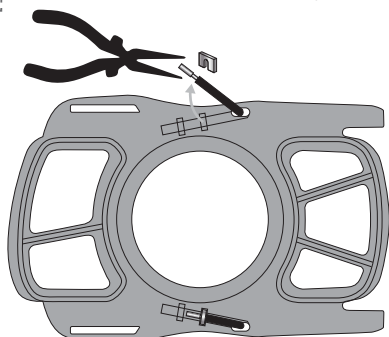

## Fuse and NX2-series

Loosen Snaplock bolt  
with Philips #3  
screwdriver.

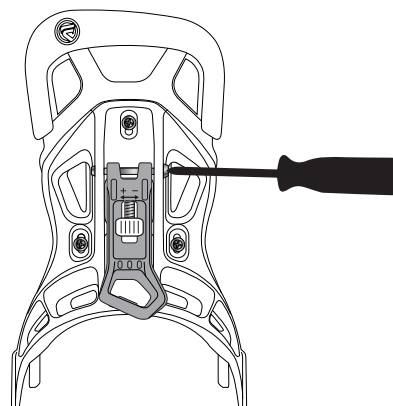

Replace Snaplock, and  
re-assemble. Tighten  
bolt back into place.

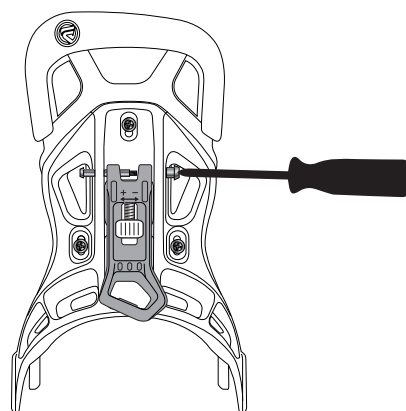

Undo the cable-termination from baseplate to disassemble and re-assemble cable  
through the snaplock.

On NX2-Series: Loosen  
Cable-termination bolt  
with Philips #3  
screwdriver. Reassemble  
back in same position,  
make sure bolt is securely  
tightened.

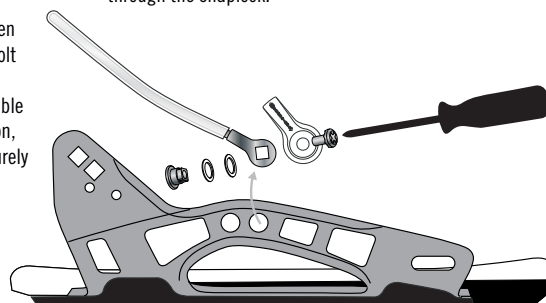

On FUSE-Series: Undo  
side-wing bolt with Philips #3  
screwdriver. Tilt side-wing to  
undo cable-termination pin.  
Reassemble back in same  
position and make sure bolt  
is securely tightened.

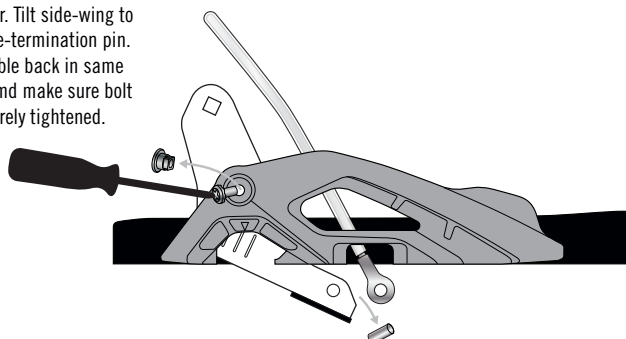

**IMPORTANT NOTE:** Be sure that all parts are assembled correctly and secure, failure to do so may cause serious injuries. Flow recommends that any and all service and repairs to your bindings be done by a trained, professional mechanic. For our full liability policy, how-to tricks and tips and more, please visit [WWW.FLOW-SNOWBOARDING.COM](http://WWW.FLOW-SNOWBOARDING.COM)





# POWERSTRAP CONVERSION

## FUSION

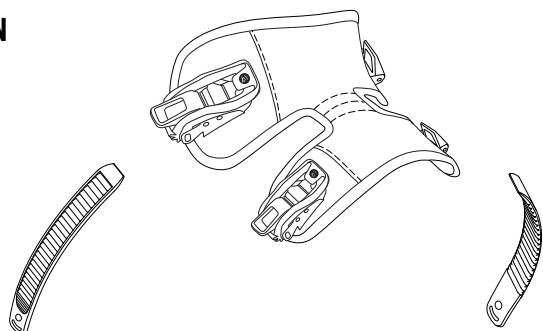

Use straight  
LSR front ladder

Use straight QuickSet  
front ladder

Note: Ankle ladderstraps do not need to be replaced

## HYBRID

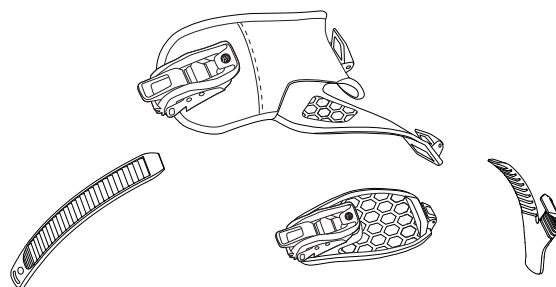

Use straight  
LSR front ladder

Use Y-shaped QuickSet  
front ladder

Note: Ankle ladderstraps do not need to be replaced

## NX2-series

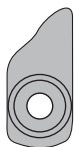

Use ladderstraps  
with this bottom  
shape, and use  
original hardware

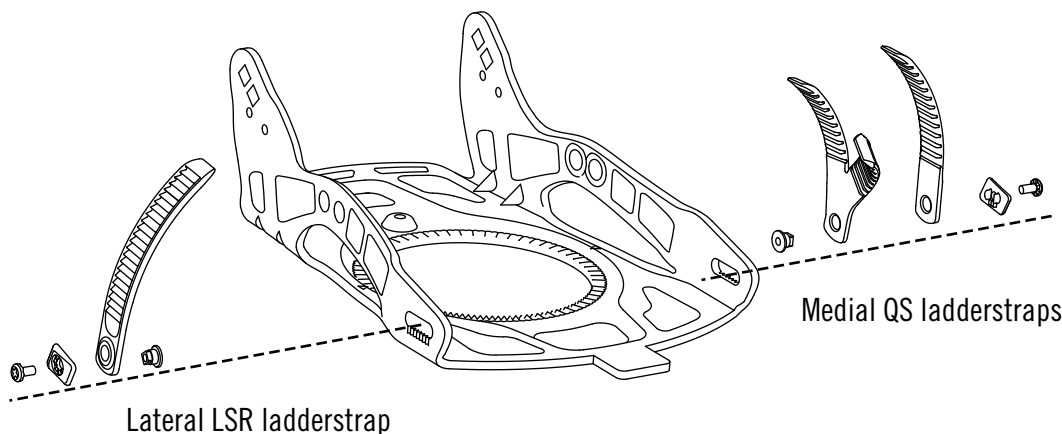

Lateral LSR ladderstrap

Medial QS ladderstraps

## FUSE, AXIS & H-series

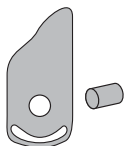

Use ladderstraps with  
this bottom shape and  
attachment pins.  
Insert ladderstraps from  
top into the slots, add  
stopper pins into ladders  
from bottom.

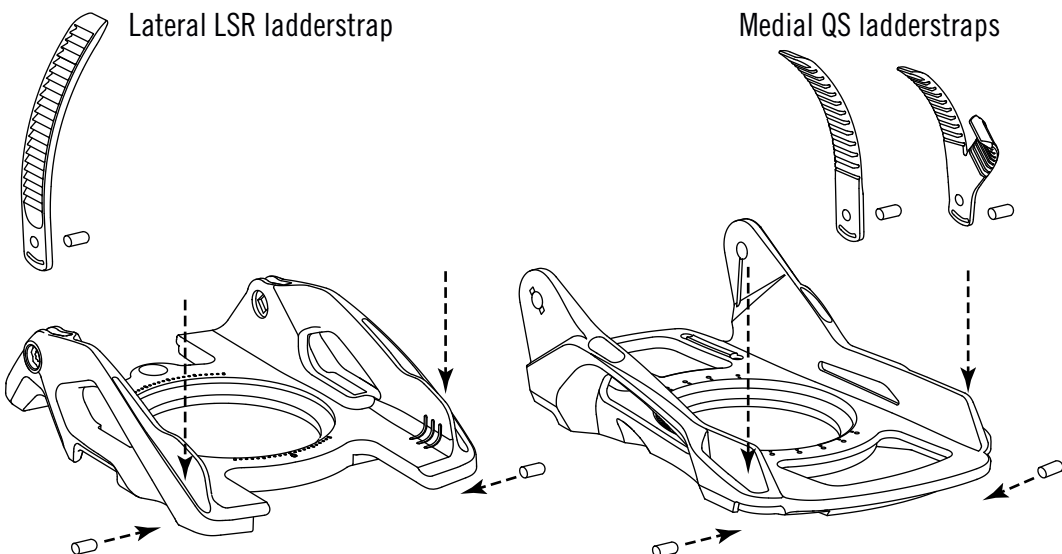

Lateral LSR ladderstrap

Medial QS ladderstraps



**IMPORTANT NOTE:** Be sure the ladderstraps and buckles are securely connected before going riding. Failure to assemble the parts correctly may cause serious injuries. Flow recommends that any and all service and repairs to your bindings be done by a trained, professional mechanic. For our full liability policy, how-to tricks and tips and more, please visit [WWW.FLOW-SNOWBOARDING.COM](http://WWW.FLOW-SNOWBOARDING.COM)







# BINDING USE TRICKS&TIPS

**EASY: Set-it & Forget-it!** Set the PowerStrap position once, Enter&Exit through the reclining hiback. Or use the buckles to open & close the PowerStrap and Enter&Exit from the side.

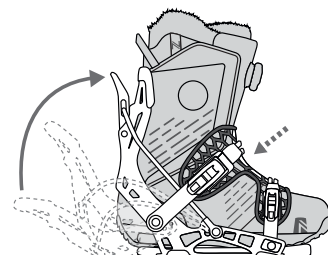
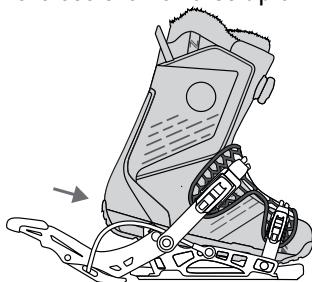
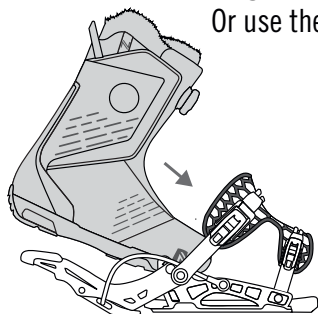

Enter your Flow bindings (always enter FRONT foot FIRST):

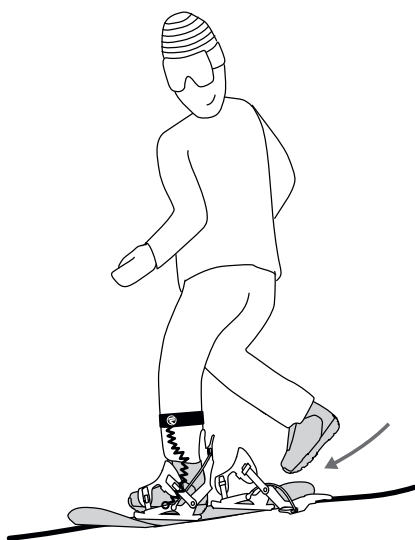

On flatter areas: Heelside

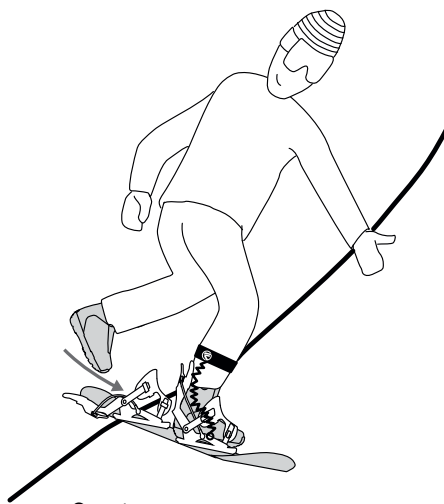

On steeper areas:  
Face the hill toeside

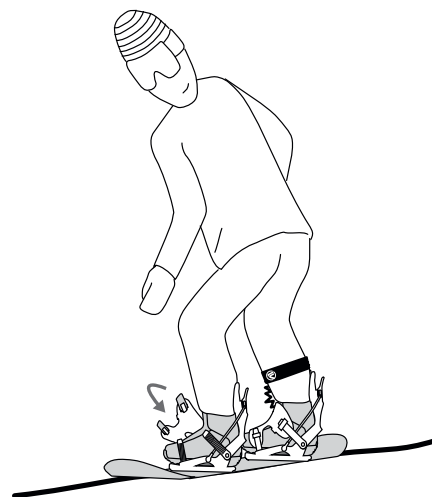

Or use the buckles any time:  
Dual-Entry

Exit from Flow bindings: Simply bend your knees and open the Snaplock lever (always exit REAR foot FIRST). Or use the buckles to exit from the side.

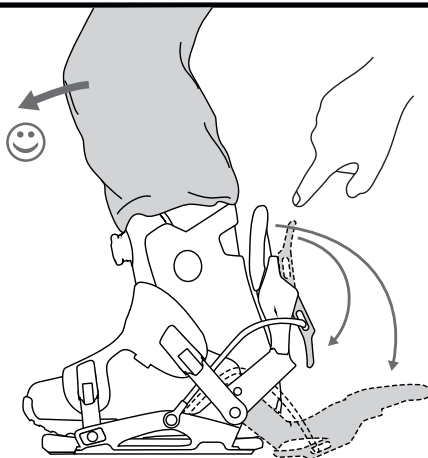

push lever away from hiback

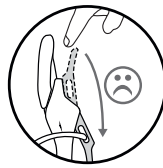

do NOT try push lever downward

Adjust buckles & forward-lean

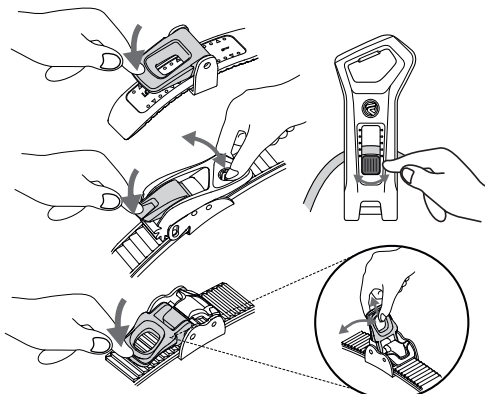

Practice getting in and out of your bindings and make sure the hiback can close securely and open freely. Your board should be attached to you with an approved retention device at all times while riding or walking. If a retention device is removed, for any reason, turn the board upside down and push the bindings securely into the snow to prevent runaways. Flow Snowboard bindings are "non-release", and are designed to remain affixed to your feet under most circumstances as set out per ISO14573. However, under some circumstances, bindings may become separated from your boot. Unusually serious injuries may occur when only one foot is secured in the bindings while riding. Use a Snowboarding helmet and protective body gear. Snowboarding is a hazardous activity with unexpected dangers. The use of snowboarding equipment, including getting "air" and the use of any natural or man-made terrain feature, involves the risk of serious personal injury to any part of the user's body, dismemberment or death. Hardware can loosen so always check your fasteners before you go riding, and make sure no other parts are broken or missing. While getting onto a chairlift, fold down the hiback of the unsecured foot. Familiarize yourself with any terrain before using it, including any natural or man-made terrain features. Obey all mountain rules and signs as well as all and any laws, regulations and Responsibility Codes. Do not rest your snowboard on your back boot to prevent damage to your boot. Flow recommends that any and all service and repairs to your bindings be done by a trained, professional mechanic. For our full liability policy, how-to tricks and tips and more, please visit [WWW.FLOW-SNOWBOARDING.COM](http://WWW.FLOW-SNOWBOARDING.COM)